

Bluetooth® Receiver Wallplate and Backbox

Item ref: 122.380UK

User Manual

A Bluetooth receiver conveniently housed in a standard 1gang plastic wallplate which allows connection of Bluetooth enabled devices such as smartphones, tablets, iPods etc. Ideal for use in classrooms, boardrooms, kitchens or home studies the unit comes supplied with a UK power supply and a 50mm back-box for easy installation.

Technical Specifications and Features

Audio inputs	Bluetooth receiver or stereo audio line level
Audio source select	AUX automatically enabled when device plugged into the AUX port
Audio output	Stereo audio phone jack or 3-pin Screw terminal
Power input	Power jack or 2-pin Screw terminal (5VDC)
Stereo audio output	For connection to any speaker system
Bluetooth version	3.0 EDR compliant
Bluetooth reception distance	Up to 10 Meters
Power source	5VDC/1A
Power rating	1/P 100 - 240 Vac, 200 mA, O/P:5 Vdc,1000 mA
Operating Temperature	0°C~40°C
Dimensions	87 x 87 x 35 (wallplate only)
Weight	48g

Bluetooth Pairing Instructions

- To enter Bluetooth mode press the pairing button for 3 seconds, press again for 3 seconds to turn off.
- When the device is in Bluetooth mode the BT status light flashes quickly.
- For first time pairing, hold down the Pairing button for 5 seconds until the BT status light flashes slowly. (The device pairing name is Music BT01)
- The pairing timeout limit is 90 seconds.
- If pairing has timed out, you need to hold down the pairing button again for 1 second to re-enter pairing mode.

Bluetooth Blue LED Status

- Bluetooth mode: Fast flash (approx. 2 per second)
- Pairing mode: Slow flash (approx. 1 per second)
- Linked mode: Always on
- AUX mode: LED off

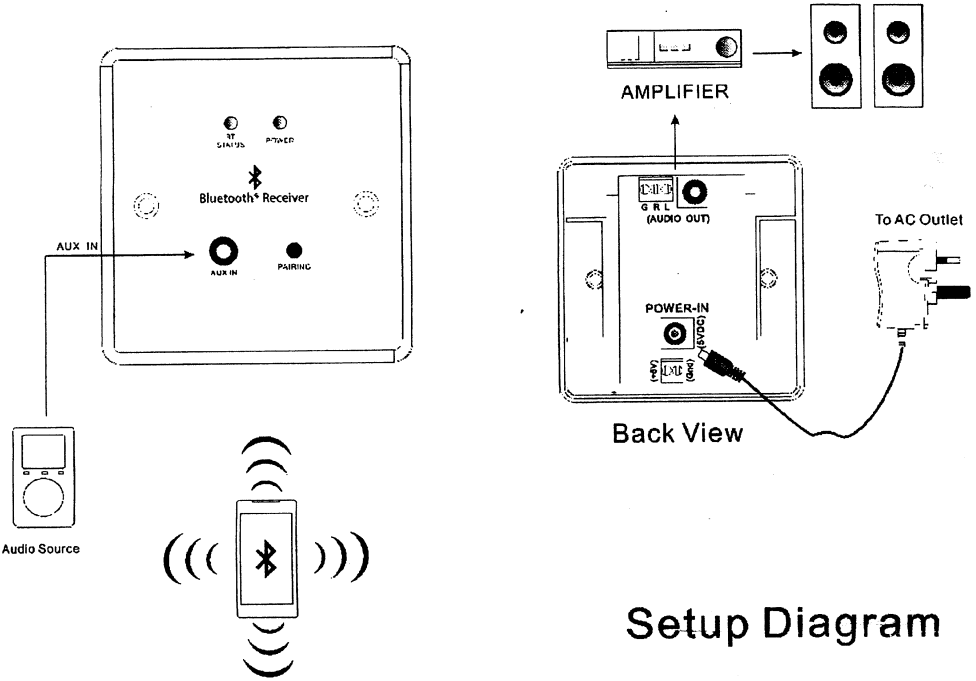

Setup Diagram



This product is classed as Electrical or Electronic equipment and should not be disposed with other household or commercial waste at the end of its useful life. The goods must be disposed of according to your local council guidelines.

*Errors and omissions excepted.
Copyright© 2016. AVSL Group Ltd.*